

APPENDIX

Regional activity home DONTOKOI MINAMI

Regional activity home
DONTOKOIMINAMI

**“Live in your own way and in your community,
with visible peace of mind.”**



A social welfare corporation Yokohama-Kyoseikai
Regional activity home DONTOKOIMINAMI

4-270-3 Nakamura-cho, Minami-ku, Yokohama-shi 232-0033

TEL 045-264-2866 FAX 045-264-2966

MAIL dontokoi@y-kyousei.or.jp

URL <http://www.y-kyousei.or.jp/dontokoi/>

Guide to activities

<p style="text-align: center;">Consultation (Care management)</p> <p>Please consult with us on any matter that concerns you. We will provide (and manage) services that meet your use needs.</p>	<p style="text-align: center;">Regional exchange</p> <p>Support for volunteer activities We provide a venue for volunteer activities while building volunteer networks, holding events, and providing training</p>
<p style="text-align: center;">Living support (temporary care, short stay)</p> <p>We can provide care on behalf of family members during family emergencies or hospitalization, or when they go shopping, travel, or participate in ceremonies or special events. This service is available for short periods of time or several days.</p>	<p style="text-align: center;">Toy library(Minamikko Room)</p> <p>With many toys, a sandbox, and a pool, the toy library offers a place for play, meeting friends, and interchange.</p>
<p style="text-align: center;">Support of leisure activities</p> <p>We plan various events and social gatherings to help everyone with disabilities enjoy their holidays and leisure time.</p>	<p style="text-align: center;">Day services</p> <p>We support the social participation of people with disabilities through our workplaces and activity venues.</p> <ul style="list-style-type: none"> • Bread shop, coffee shop • Handmade crafts shop (creative activities) • Outdoor activities • Light work ※ “Jushin B” day services
<p style="text-align: center;">Various other services</p> <p>We will coordinate our services to meet your needs.</p>	

DONTOKOIMINAMI

Our aims

No matter the subject, we will take whatever time is necessary to address concerns together with our users. We will see no problem as impossible to solve.

By coordinating existing services and quickly addressing individual needs in every way possible, we will become a community mainstay that helps both disabled people and their families live in the region with peace of mind.

We will view communication, cooperation, and exchange as essential elements of community development.

We will value the individual, and support each person’s personal choices and decisions.

Facility outline

2F

Bath Room

Size 1,500m²

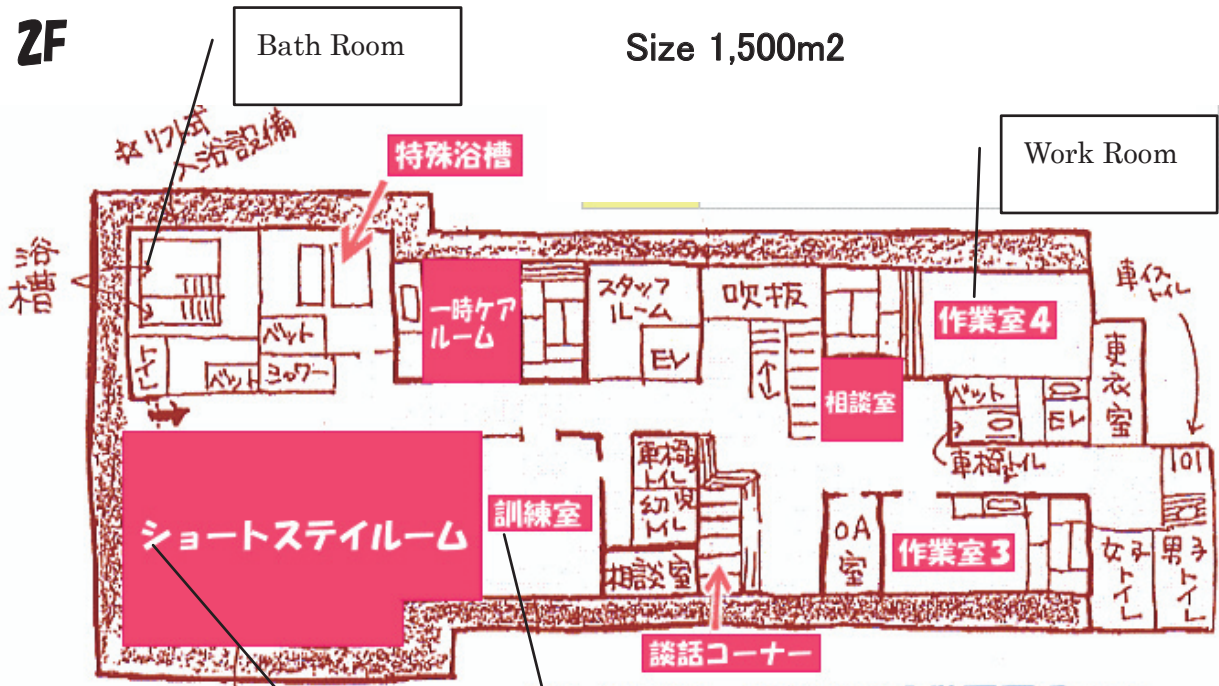

ショートステイ!!

Shortstay

Training Room

1F

Regional exchange Room

Cafeteria

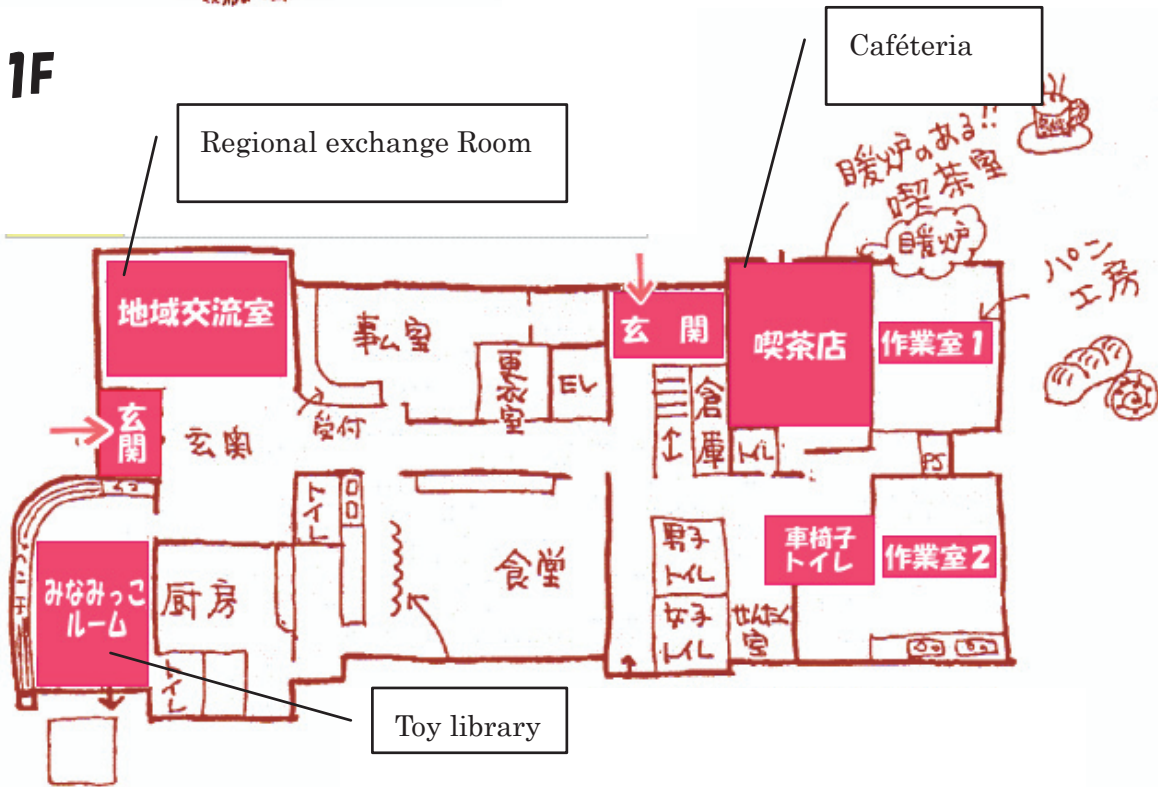

Toy library

DONTOKOI MINAMI

Regional activity home DONTOKOI MINAMI : Number of users (service recipients) in the fiscal year of 2006

	Month	Total in the fiscal year of 2005	4	5	6	7	8	9	10	11	12	1	2	3	Total
Consultation (Care management)	Number of newly registered users in the month	225	10	10	18	17	10	9							74
	Gross users of consultation services (previously registered users)	735	128	91	155	154	100	121							749
	Total of registered users	681	691	701	719	736	746	755							755
Day services	User capacity (including both "physical disabilities" and "intellectual disabilities" sections)	46	46	46	46	46	46	46							46
	Number of days they provide "Day services"	243	20	20	20	20	23	20							123
	Registered users with physical disabilities	55	37	51	41	41	40	38							51
	Gross users of "Day services" (physical disabilities)	3167	228	247	275	235	243	225							1459
	Lunch service	3059	222	234	267	226	237	225							1459
	Bath service	964	62	73	81	77	78	72							443
	Transportation service	4855	338	385	398	353	368	343							2185
Day services	Average number of users (physical disabilities)	13	11.4	12.4	12.5	11.7	10.6	11.5							12
	% (Average number of users with physical disabilities/ User capacity of 23)	58%	50%	54%	54%	51%	46%	50%							51%
	Registered users with intellectual disabilities	62	51	66	54	56	56	57							66
	Gross users of "Day services" (intellectual disabilities)	5172	424	429	469	416	484	451							2673
	Lunch service	5157	431	438	478	424	491	459							2721
	Bath service	95	1	0	0	0	1	1							3
	Transportation service	5470	509	494	531	488	544	500							3066
	Average number of users per day (intellectual disabilities)	21	21.2	21.5	21.3	20.8	21.1	22.5							21
% (Average number of users with intellectual disabilities/ User capacity of 23)	93%	92%	93%	93%	90%	92%	98%							93%	

“Day services” for persons with severe multiple disabilities	User capacity	5	5	5	5	5	5	5								5
	Number of days they provide “Day services”	22	20	20	22	20	23	20								125
	Gross users of “Day services” (severe and multiple disabilities)	33	97	117	101	99	125	95								634
	Lunch service	33	96	105	98	97	118	90								604
	Transportation service	57	184	191	15	179	217	176								962
	Average number of users per day (severe and multiple disabilities)	1.5	4.9	5.9	4.6	5.0	5.4	4.75								5.1
	% (Average number of users with severe & multiple disabilities/ User capacity of 5)	30%	97%	117%	92%	99%	109%	95%								101%
Short stay services (overnights stay)	Number of people who stay	510	43	47	48	58	57	52								305
	Gross users of short stay services	963	74	76	82	108	100	81								521
	Average number of users per day	2.6	2.5	2.5	2.6	3.5	3.2	2.6								2.8
	Actual count of users	499	43	47	47	58	57	52								304
Temporary care (day time)	Number of service provision	2609	284	311	313	349	360	290								1907
	Hours of service provision	9821	1049	1082	1088	1441	1716	1037								7413
	Numbers of transportation provision for the service	888	141	151	117	117	27	138								691
Support of leisure activities	Number of service provision	20	2	1	0	2	6	2								13
	Number of participants	81	8	3	0	7	19									37
Toy library	Adult users	1683	120	154	190	209	197	152								1022
	Child users	2057	135	160	218	244	253	171								1181

Number of registered users of “Day services” (at May 31st, 2006)

Ward in which users inhabit	Physical disabilities	Intellectual disabilities	Total
Minami-ward	26	45	71
Names of other wards in Yokohama-city	4	3	7
Names of other wards in Yokohama-city	5	2	7
Names of other wards in Yokohama-city	11	11	22
Names of other wards in Yokohama-city	3	2	5
Names of other wards in Yokohama-city	1		1
Names of other wards in Yokohama-city		2	2
Names of other wards in Yokohama-city	1		1
Names of other wards in Yokohama-city		1	1
Sum of users from other wards	25	21	45
Total of users	51	66	117